

Technical Specifications Barney Danson Theatre



The Barney Danson Theatre is a multipurpose, multifunctional space. It is equipped with cutting-edge audio, lighting and video technology, and can be used as a conventional theatre, a lecture hall, and a banquet hall, often at the same time. To make this possible, the room is provided with a movable proscenium arch, a collapsible stage and retractable bleacher-style seating. As a result, the space is ideal for performances, conferences, receptions and gala events. The technical specifications below are based on a theatre-style configuration with bleacher seating.

**The information in this document is subject to change without notice.*

The Space

Area

- 3,900 ft²/1,188 m²
- Sealed (varnished) concrete floor

Maximum Capacity

- 231 — theatre configuration with bleacher seating
- 200 — sit-down banquet
- 250 — cocktail-style event

Control Booth (sound, lighting and projection)

- The control booth is located across the stage, 17.3 metres (57') from the upstage wall, at an elevation of 3.53 metres (11' 6').

Access for the Mobility Impaired

- The space is located on the Museum's main level.
- A ramp can be installed to provide access to the stage.

Service for the Hearing Impaired

- Service is available on FM frequencies, broadcasting a continuous signal.
- FM receivers are available for users.

Simultaneous Translation

- A permanent booth is available in the control booth.
- A portable two-language Listen system is available, broadcasting on the FM band.

Green Room

- The hall is equipped with a multifunctional green room furnished with couches, tables, a washroom, a shower, a refrigerator, a makeup area and an iron and ironing board. The green room allows access to both sides of the stage/hall.

Proscenium Arch

- The hall is equipped with a movable proscenium arch.
 - Dimensions: Width: 13.89 m (45' 6"); Height: 5.15 m (22' 8")
 - Opening: Width: 9.85 m (32' 4.5"); Height: 5.15m (17' 6")
 - In retracted position (against upstage wall): 1.03 m (3' 5")
 - In fully extended position: 5.05 m (16')
 - Movable distance: 4.15 m (13')

Stage

- Area at fullest extent: 9.75 m (32') wide by 4.87 m (16') deep, and 0.61 m (24") high. Access to the stage is provided by portable stairs.
- Composed of Wenger Versalite risers, each measuring 1.22 m x 2.44 m (4'x8')
- Standard stage area: 7.31 m wide by 3.65 m deep (24'x 12').
- Width not including wings at stage left and stage right: 2.43 m (8').
- Distance between the front edge of the stage and the control booth 12.49 m (41').
- Distance between the front edge of the stage and the bleachers 4.27 m (14').

Battens

- Total: 7 single fixed battens
- Height of battens in stage area 6.75 m (22'); outside stage area: 7.36 m (24')
- Maximum equipment load: 11.4 kg (25 lbs) per linear foot
- Length of battens before the proscenium area 18.3m (60')
- Length of battens inside the proscenium arch: 13.41m (44')
- Diameter of battens: 3.7cm (1.5")

Curtains

- The main curtain is electrically controlled from the control booth and from the proscenium—black and beige Saltex polyester/polyacrylic with felt backing 225% fullness.
- Legs: 1 on each side measuring 5.17 m H x 4.55 m W (17' H x 15' W)
- The hall has 3 pairs of removable acoustical borders at ceiling height.

Auxiliary Power

- 1 Camlock 3-phase power supply 100A/120/208V — stage right
- 1 Camlock 3-phase power supply 100A/120/208V — storage area

Technical

The space has permanent technical equipment. We also have a wide range of portable equipment which can be used in the hall, depending on availability and the type of event.

Sound

- Crest X-VCA — 20 microphone inputs, 8 stereo line inputs, 8 sub group, 8 VCA
- 3 Sennheiser ew500 G2 wireless microphones with handheld, lavalier or headset microphone
- 8 Channel Ashly Protea Digital Equalizer
- Ashly Protea System II Digital Equalizer — slave
- TC Electronic M-One Digital Reverb Processor
- TC Electronic D-Two Digital Delay
- DBX 1046 Quad Compressor
- DBX 1074 Quad Gate
- Denon DN-300Z Media Player (CD,SD,USB,FM)
- Marantz CDR-510 two-disc CD-R/RW
- Speakers: Central group and on right and left side: Meyer UPJ-1P (1 for each position)
- Speakers—around the hall (for 5.1 digital surround sound): JBL 8340

Permanent Lighting Equipment

- Lighting Console: ETC Express 48/96
- Dimmers: 192 Strand 2.4 kW dimmers
- Circuits: Total of 192 @ 20 A
- 31 — Strand Zoom Leko 23/50 degrees 575 W
- 6 — Source Four 575 W PAR Medium
- 8 — Altman 575 W PAR Medium
- Wide range of Roscolux colours

Projection

- The space is equipped with a Blu-Ray player and video projector.
- Distance to the screen: 17.37 m (57')
- Type of screen: Da-Lite (18' W x 10' H)
- Height of screen: 1.82 m (6') from finished floor
- Digital 5.1 surround sound system

Communications System

- Full Clear-Com system available

Main entrance
Entrée principale

Group entrance
Entrée des groupes

Administration Shipping
Quai de l'administration

Parking
Stationnement



Artefacts shipping
Quai des artefacts

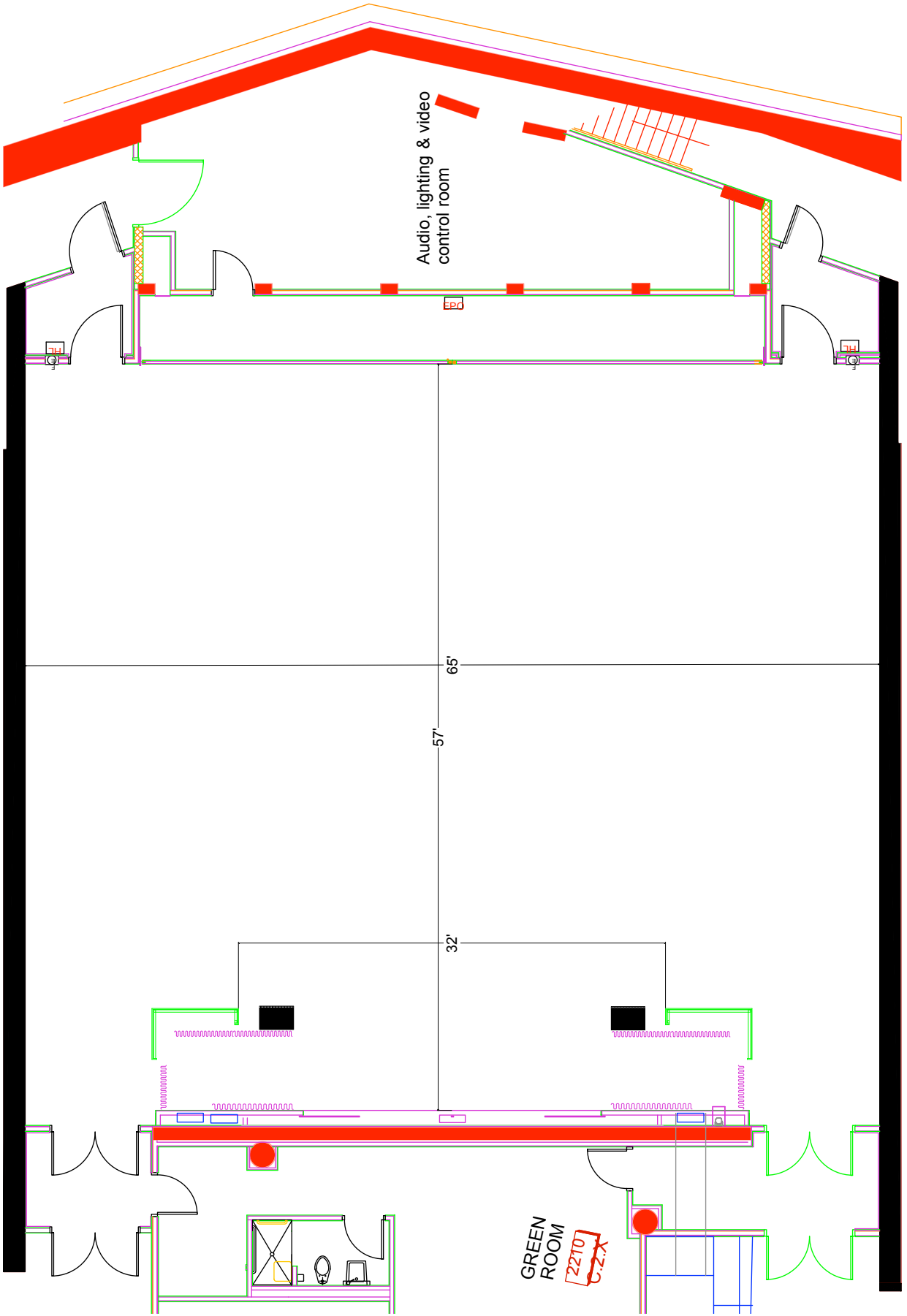

Audio, lighting & video control room

65'

57'

32'

GREEN ROOM
22101
G.2.A

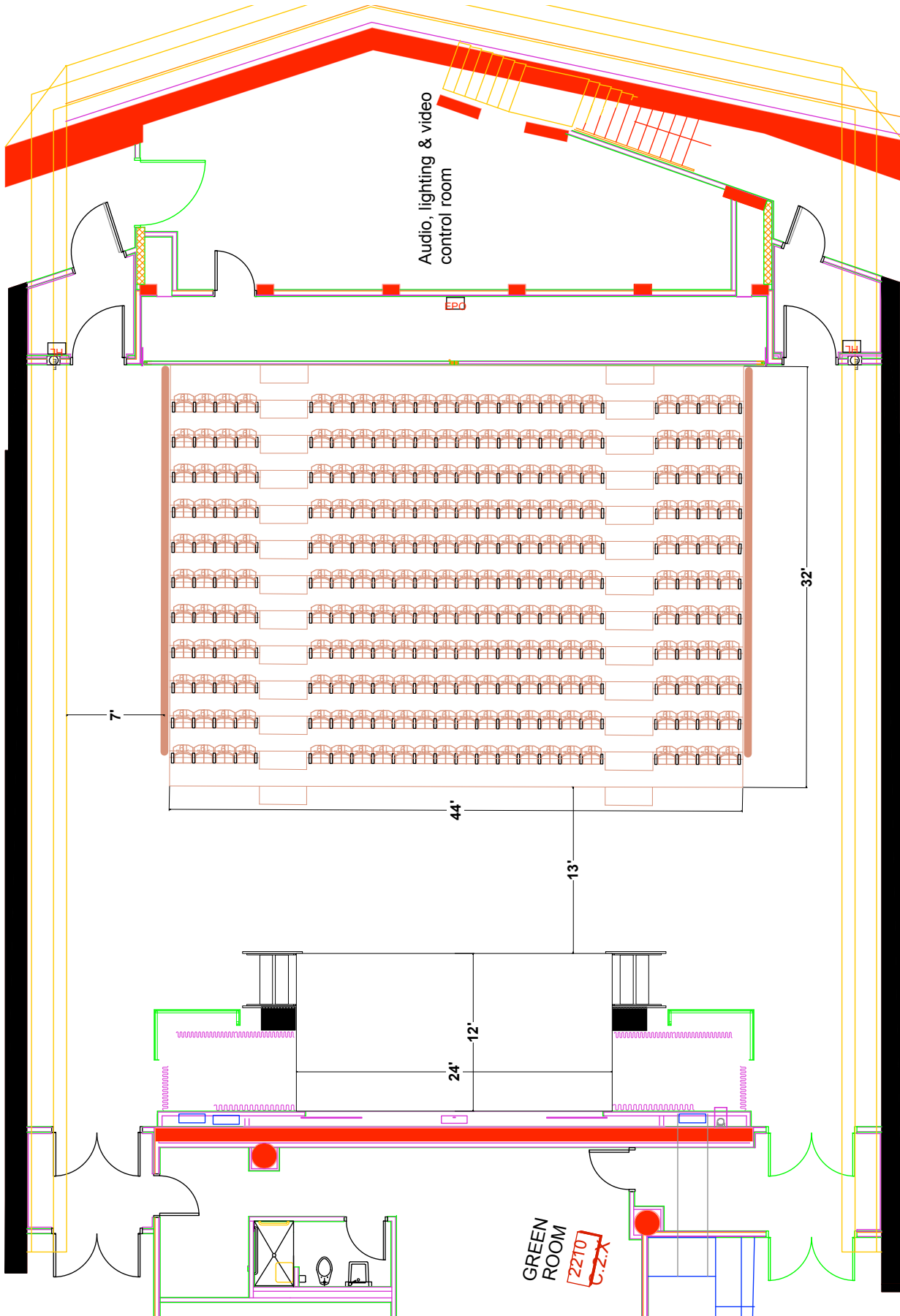

HOUSE PLOT

